

# RS655 Sweeper

SERIES RS655

ISSUE NUMBER 01-19

REFERENCE JS 0119



113" CA

178" WB

296"

113.5"

92"

FRONT MOUNTED STORAGE BOX ADDS 16" • REAR CATCH BASIN CLEANER ADDS 10"

## Data & Performance

### Sweeping Equipment

Gutter broom	44"; forward-facing, unhandled design
GB life expectancy	80 accumulated working hours
Pick up hood width	93" with 2" wide carbide skids
Nozzle trunking material	Flexible rubber, steel reinforced
Pressure hose diameter	14" dia, 3/8" thick
Suction hose diameter	14" dia, 3/8" thick

### Chassis Data - Single Engine Design

Chassis requirement	33,000-35,000 LB
Wheelbase	164" - 178" ( <i>chassis dependent</i> )
Engine Model	Cummins L9 - 300HP
Cubic capacity	9 litres
Gross rated power	300 HP @ 2000 RPM
Maximum torque	860LB/FT @ 1300 RPM
Transmission	Allison 3500 RDS Automatic with Dual PTO Provisions

### Capacities

Hopper usable volume	8.5 yd <sup>3</sup>
Hopper construction	9 gauge stainless steel <b>LIFETIME WARRANTY NO PRORATION</b>
Fuel tank	50 gallons
Water tank	300 gallons
Hydraulic system	20 gallons

### General Data

Dump height	39" ( <i>chassis dependent</i> )
Dump angle	55° nominal
Door opening angle	125° nominal
Filter mesh area	2500" <sup>2</sup>
Water pump output	Up to 9.2 GPM
Dust spray water pressure	50.75 PSI
Hydraulic suction filtration	125 micron
Hydraulic return filtration	20 micron
Hydraulic pump displacement	Max output 8.7 GPM
Sweeping speeds	1-10 MPH ( <i>debris dependent</i> )

We are **THE ONLY** sweeper manufacturer to offer an **all-inclusive warranty (2 years/2,000 hours)** and an **"entire debris hopper" constructed of stainless steel as a standard with a LIFETIME WARRANTY.**



**Endless Sweeping Solutions™**

105 Motorsports Road, Mooresville, NC 28115  
T 704.658.1333 F 704.658.1377

**JOHNSTONSWEEPERS.US**  
a **BUCHER** company

Due to continuous product development Johnston Sweepers reserves the right to alter specifications without prior notice. Copyright © 2019 Johnston Sweepers RS655SPEC.0119

# RS655 Sweeper

SERIES RS655

ISSUE NUMBER 01-19

REFERENCE JS 0119

## Technical Specifications

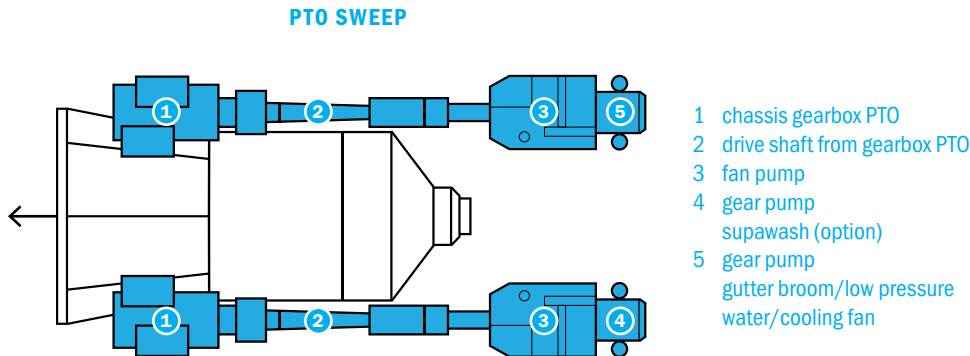

### Fan System

Heavy-duty stainless steel dynamically balanced impeller with backward-curved multi-vane blades

Operational speed variable between 2400 - 3000 RPM to easily adapt to application.

Driven via a direct coupled hydraulic motor  
**5 YEAR WARRANTY**

PTO ratio - 1:1.29

### Gutter Broom

44" forward-facing digger-style, unhandled design

In-cab down pressure and variable speed controls (0-135 RPM).

Three preset lateral working positions (*narrow/standard/extended*).

### Pick up Head

93" forward and reverse debris pick-up low-noise suction system with 14" diameter suction and pressure hoses.

In-cab variable control vacuum enhancer

144" sweep path with (2) gutter brooms

### Dust Suppression System

Dust suppression water nozzles located in suction tube (2), gutter brooms (8), inside of hopper (2) and front-mounted chassis spray bar (4).

H.D. Twin diaphragm water pump driven hydraulically from a direct-coupled motor; self-priming and able to run dry without damage.

Water winterization purge system.

### Electrical System

All internal and external wiring conforms to IP65 and IP67 standards-waterproof and dustproof.

12 v system is integrated with the truck chassis for easy troubleshooting.

Electric over hydraulic backup system.

### Debris Body LIFETIME WARRANTY

8.5 yd<sup>3</sup> hopper and full auxiliary engine cowling. Fabricated from heavy duty 9 gauge stainless steel.

Access doors fitted on both sides with safety grab handle and step to allow for screen and body load inspection.

Separate polyethylene water tank incorporates anti-surge baffles and filled via water hydrant.

Rear discharge chute and twin rear LED beacons with guards.

Single lock rear door latching system with (2) de-watering drain ports.

Hopper deluge and dust separator washout system.

Automatic deploying multi-position full width body propping mechanism.

Service ladder and platform.

Hydrant hose & wrench with lockable storage basket.

## Controls

In-cab mounted master switch panel housing sweep controls condition status indicator lamps, including:

- Raised hopper warning
- Auxiliary engine hour counter
- Equipment fuel gauge
- Low-level lost water
- Engine tachograph meter
- Low level hydraulic oil indicator
- Recall sweep-sweep pause & resume
- Reverse auto sweep interrupt

## In Cab Noise

<75 dB(A) - (chassis dependent)

## Exterior Noise/ Sound Power Level

L<sub>WA</sub> 110 dB(A) for turbo-charged engine measure in accordance with EC directive 2000/14/EC.

## Options

- Camera monitoring system
- Pneumatic hopper screen shakers
- Rear-mounted hydraulic power-assisted 8" wanderhose
- Rotatilt in-cab gutter broom tilt
- Rear LED work lights
- Supawash - high pressure washing system  
8.5 gallons/min @ 1500 psi bar. Handlance & hose reel, front-mounted high pressure spray bar optional .
- Gutter broom extension override (GEO)  
Infinitely variable lateral positioning. Allows operator to sweep anywhere from retracted in front pick-up head to maximum extended positions. Eliminates need for broom in head.
- PM 10 certified
- Bonded intake components

A comprehensive range of additional options are available. Please ask for details.



JOHNSTONSWEEPERS.US

a BUCHER company